

FastSHAPES®

THICK PLATE DEVELOPMENTS



Ideal for Boilermakers, Draftsmen & Engineers

UFOLDING & FOLDING LAYOUTS FOR INDUSTRIAL FABRICATORS

HIGHLIGHTS:

- INCLUDES COMMON, COMPLEX AND HEAVY CONSTRUCTION SHAPES
- PRODUCTION-READY FLAT PATTERNS
- FULL MANUFACTURING AND WELD DETAILS
- EASIER THAN CAD!
- DXF OUTPUT
- MICROSOFT WINDOWS

The FastSHAPES® System contains a full suite of programs designed to automatically create flat pattern developments for both common & complex fabricated items.

Shapes can be completed in a fraction of the time manually lofted patterns would allow and importantly, they are fabricated "right first time".

Simply model the item in 3D (you see the shape appear as data is entered) and produce output for cutting or manual lofting.

FastSHAPES® automatically

produces meaningful data for the forming and joining of parts when appropriate.

The system is sophisticated but uses familiar shop floor terminology making it very

easy to learn with 'user tips' and a comprehensive online help system

With shapes covering most thick development needs, FastSHAPES® offers dramatic benefits to any heavy fabrication related business.

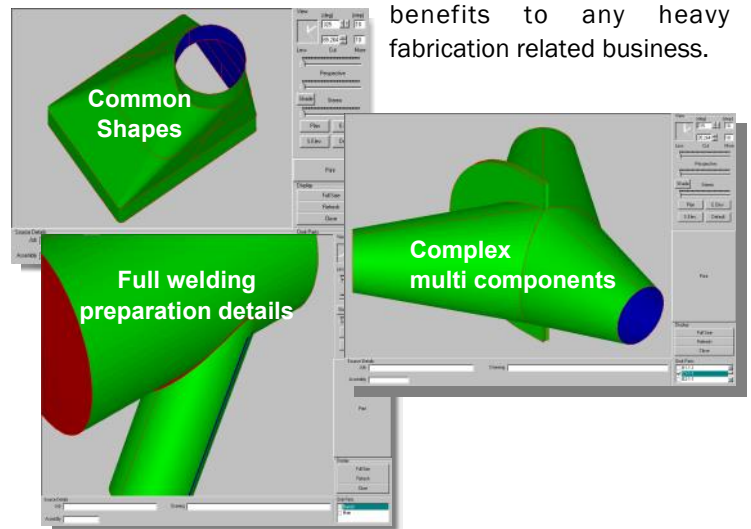

FastSHAPES® is for medium to heavy plate manufacturing where the main joining technology is welding.

Features:

Dynamic Display changes shape as data is entered

Full 3D Viewing inc stereoscopic, Plan, Elevation & Isometric

'Cutaway' feature lets you see inside the development

Calculates Bend Lines, Forming Angle, Longitudinal Seam Off-sets and more

Every component of a construction can be viewed independently

Plotted layouts

2D & 3D DXF CAD output of shapes and flat pattern

"RIGHT FIRST TIME"

Take out the guesswork and eliminate the need for calculations!

This computer based system can handle thousands more computations which is reflected in the capacity and accuracy of the system. Particularly when compared to hand lofted pattern developments.

FastSHAPES® produces clean and precise geometry that you can export as a DXF (CAD) file or into your CAM system for editing and/or nesting if desired.

Highly accurate components offer a marked improvement in weld quality and consistency resulting in better fitup.

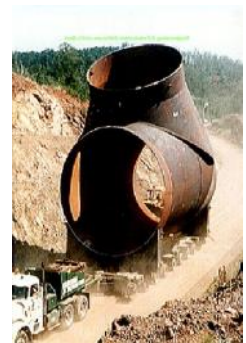

FastSHAPES® completed this complex hydro-electric component in only minutes ready for burning, with all forming details and even plate edge preparation (PEP).



DESIGNED FOR REALWORLD APPLICATIONS



FastSHAPES® offers the most dramatic savings when working with :

- Large fabricated shapes which require a lot of additional fabrication information (often multi-segmented).
- Complex equation based developments such as gears.
- Predictable multi-component developments.

FastSHAPES® was specifically designed to be able to handle medium and thick plate. The program has been used in real world production solutions since 1989.

Pipe branches, transitions, heavy ducting, anything for Hydro-electric, mining infrastructure or general heavy fabrication are handled superbly.



FastSHAPES® has been used in the development of Naval Frigates and nuclear and conventional submarines

FastSHAPES® has proven to offer substantial time & material savings ranging from mining buckets to wind-farm towers.

These large conical structures are used to support Turbines at a Wind Farm.

DEVELOP A FULL RANGE OF 'PRODUCTION READY' PATTERNS

Common Blowpipe

Rectangle to Round, Elbow, Pipe Branch, Lobster, Multi Segment Cone, Oblique Cone, Cone Bifurcate, Plate Branches.

Power Transmission

Chain Sprocket, Universal Sprocket, Rack and Pinion, Involute Gears.

Heavy/Complex Transitions

Tapered & Transforming Lobster-back Bends, Offset & Mitred Transformers, Conical Branches, Conical & Tubular Runs, Simple & Complex Bifurcations.

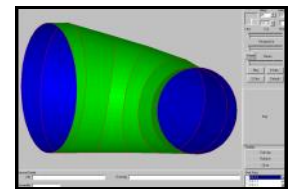
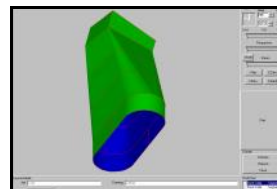
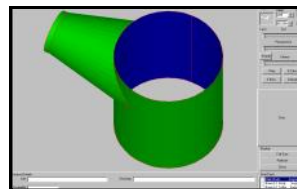
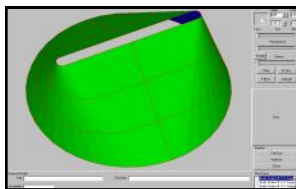

Note: With over 20 shapes in the library, FastSHAPES® covers most of the shape development needs of fabricators and service centers.

Makes easy work of even complex fabrication jobs.

FULL MANUFACTURING DETAILS TO INTERNATIONAL STANDARDS

FastSHAPES® allows for multi stroke, variable thickness construction with internal, mean or outside data entry.

Full fabrication development includes Welds, Full/Partial Penetrations, Fillet, Butt/Groove.

- Green Allowances
- Forming Angle
- Back to Back "Stitch" Cutting
- Marking of bend lines
- Mass of all Parts
- Assembly List
- Longitudinal Seam Offsets

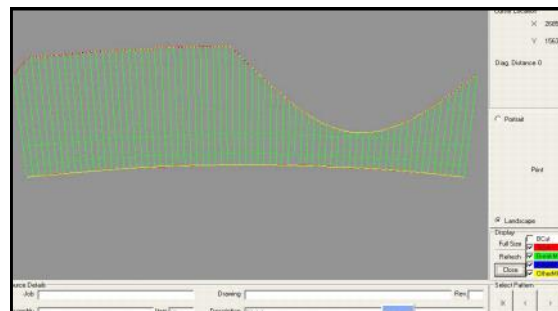
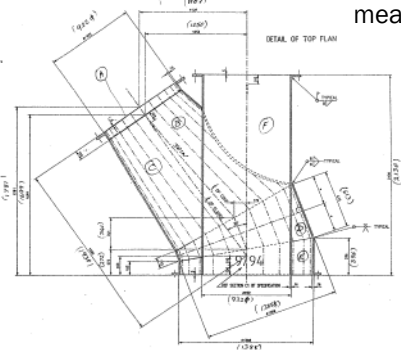



SPEED, ACCURACY & DETAILING BENEFITS ESTIMATION AND PROTOTYPING

FastSHAPES® lets you develop even the most complex parts in minutes, model the item in 3D (if required) and produce a flat pattern with all manufacturing details.

FastSHAPES® can rapidly produce useful estimation for a particular development via a Parts List (Cut Distance, Marking Distance, Mass of Cut Components).

Design Draftsmen and Engineers use FastSHAPES® to prototype designs knowing that they can be easily fabricated from plate.

2D & 3D DXF CAD outputs are very useful to take designs and patterns back into a CAD system for documentation and verification.

Note: FastSHAPES® can be used in conjunction with a CAD system however CAD is not a requirement.

“FastSHAPES® has saved us a ton of money...we now get the job done on time with no outside costs and we know it’s done right.”

Buddy Adamson,
Chief Estimator

Qualico Steel Inc-Plate Div.

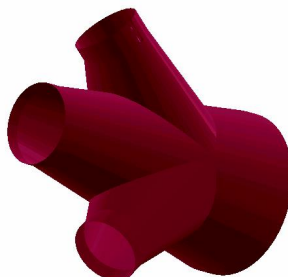
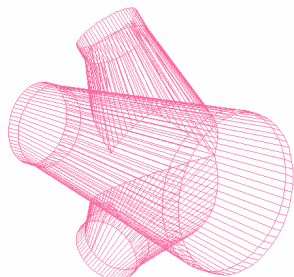

AVAILABLE IN 3 DIFFERENT VERSIONS TO MEET YOUR NEEDS

FastSHAPES® Module

Single shape only. Download.

Purchase modules as required. Does not require any other software other than Windows.

Multi Plate, Multi Thickness.

Output: 2D & 3D DXF, FastCAM file, Coordinate Table.

FastSHAPES® System

Full Shape Set as listed.

Packaged on CD.

Installs as an integrated set with software CD and security USB key (dongle) to allow for portability.

Multi Plate, Multi Thickness

Output: 2D & 3D DXF, FastCAM file, Coordinate Table.

FastSHAPES® / FastCAM® NC Bundle

Combine FastSHAPES® with the FastCAM® System for a complete NC fabrication package with nesting and post processors.

Refer to the FastCAM® System brochure for more details.

*Easy and Affordable!
Download and Use in
your Business Today!*

Note: For more details refer the FastSHAPES® Complete Technical Reference..

OFFERING SOLID SERVICE, MAINTENANCE & SUPPORT

All products are backed with 30 days support* covering installation and operation.

Free self-help is available via our web site and pay per incident support is available as and when required at fees standard for such services.

Annual Service Maintenance Agreements are also available.

SMA's give you Priority Support, Upgrades and Member Discount Entitlements.

Contact FastCAM for current pricing.

Training is now available online over the web for a fee.

CAD experience is not required however FastSHAPES® does presume a working knowledge of fabrication techniques.

Demonstration videos are on FastCAM TV. See our web site for details.



“FastSHAPES® is by far the easiest and quickest development program I have ever used”

Rick Presseau
INCO Ltd

* Technical support by phone, fax, email. Excludes on-site, installation and O/S support.

FastCAM has been supplying PC-based software for Burning, Shearing and Sawing/Drilling machines for over 25 years. The flagship product FastCAM® offers unique integrated postprocessors, NC verification and NC code nesting that still sets it apart from other CAM and CAD/CAM systems. The new generation of FastCAM® software is used in many countries, in many languages and in many different environments.

Today the product line has been expanded to include dozens of trademarked products offering a wide range of solutions for glass, timber and metal fabrication. FastCAM has OEM and Business Partners in North America, South America, China, Australia, New Zealand and Europe (Poland, UK, Czech, Hungary). We welcome all enquiries.

FASTCAM WORLDWIDE OFFICES

FastCAM Inc.—USA	FastCAM Pty. Ltd.—Asia Pacific	FastCAM— China	FastCAM— Europe
8700 West Bryn Mawr, Suite 730 South, Chicago, 60631 3507 Phone: 312 715 1535 Fax: 312 715 1536 fastcam@fastcam.com	96 Canterbury Road, Middle Park, Victoria, 3206, Australia Phone: 61 3 9699 9899 Fax: 61 3 9699 7501 fastcam@fastcam.com.au	Zhangjuang Science Park, A-318, 563 Songtao Road, Zhangjuang , Pudong, Shanghai, 201203 Phone: 8621 5080 3069 Fax: 8621 5080 3071 fastcam@fastcam.cn	Poland service@fastcam.pl

www.fastcam.com

FastCAM® works with all popular flame, plasma, laser and water jet NC cutting equipment including BURNY, EDGE, LYNX, FastCNC, HYPERTHERM, FAGOR ANCA, NUM, PDF32, SIEMENS, SYSTEM32, 40, numerical control system, and CIGWELD ESAB, MESSER, KOIKE, TANAKA, FARLEY, 3000 etc . Refer to our web site for a full listing.

Other Products by FastCAM:

The following are separate programs that can be purchased independently:

FastCAM® - CAD compatible CAM system with nesting and integrated posts.

FastCUT® for Shears & Saws— Rectangular, Linear and Cut to Length optimizer.

FastCUT® 'Active X' nesting engine allows businesses to incorporate optimization into their own custom applications.

FastCAM® QE—Quotation system with optimization for steel profiles and long products. Complete system for Steel Service Centers.

FastCAM® MTO—Capture steel take-off data electronically.

Tradesman in a Box™ - Develop heavy plate metal transitions for manual layout/lofting.

FastFRAME® and FastPIPE™ — Tubular and Pipe Development programs for heavy steel.

FastBEAM™ —Beam & Drill Line programming system for structural.

FastCOPY® —Digitize engineering parts and templates to DXF format.

FastLINK™ —Speed DNC download from PC to cutting machine.

FontGEN—Convert fonts to DXF.

Outline—Convert images to DXF.

FastTRACK® -Remnant Tracking for Processed (Cut) Plate.



www.youtube.com/user/FastCAM Service/